

# SIGNATURE

## NORTH EAST

OFFICIALLY RATED THE NO.1 ESTATE AGENT IN THE NORTH EAST





📍 Ann Street, Newcastle Upon Tyne NE27 0QR

# Ann Street, Newcastle Upon Tyne NE27 0QR

**Asking Price £75,000**

Signature North East are delighted to welcome to the market this 2-bedroom ground floor flat, located in the highly sought-after area of Shiremoor. Situated in a vibrant location, the property offers a wide range of amenities right on your doorstep. With convenient public transport options, including bus routes directly outside and the metro just a 5-minute walk away, as well as easy access to major road networks such as the A19, commuting and exploring nearby attractions couldn't be easier.

Step inside via the central hallway and you will be greeted by a spacious kitchen, featuring attractive wall and base units complemented by sleek countertops. The kitchen benefits from integrated appliances, including an oven and hob, along with a breakfast bar that can comfortably accommodate two stools. Leading from the kitchen, the large living room offers ample space for your desired furnishings, complete with a cosy fireplace and handy storage cupboard.

The property offers two well-proportioned bedrooms. The master bedroom easily accommodates a double bed along with additional furnishings, while the second bedroom is ideal for a single bed and extra furniture. Completing this floor is the shower room, fitted with a modern shower, hand basin, and W.C.

Externally, the property enjoys a shared yard, perfect for placing outdoor furniture and enjoying the fresh air. Additional convenience is provided by on-street parking to the rear of the property.



PLEASE NOTE THAT THE VENDOR HAS CERTIFIED THE PROPERTY INFORMATION AND IMAGES.

# PROPERTY FLOORPLAN

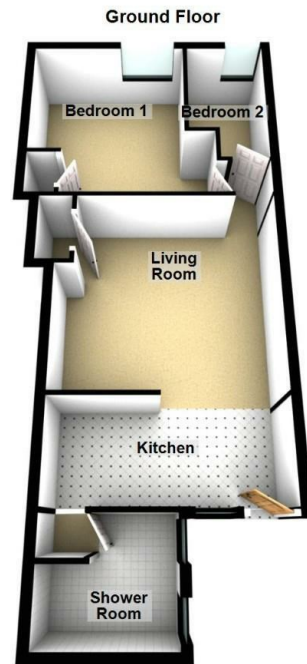

Total area: approx. 54.0 sq. metres (581.2 sq. feet)

## Measurements:

Living Room  
13'4" x 13'6"

Kitchen  
6'4" x 14'7"

Bedroom One  
12'7" x 8'8"

Bedroom Two  
9'9" x 5'7"

Shower Room  
6'10" x 7'10"

## Energy Efficiency Rating

	Current	Potential
<i>Very energy efficient - lower running costs</i>		
(92 plus) <b>A</b>		
(81-91) <b>B</b>		
(69-80) <b>C</b>	72	75
(55-68) <b>D</b>		
(39-54) <b>E</b>		
(21-38) <b>F</b>		
(1-20) <b>G</b>		
<i>Not energy efficient - higher running costs</i>		
<b>England &amp; Wales</b>	EU Directive 2002/91/EC 	





More 5 Star Customer Reviews than any other Agent based in the North East on allAgents.co.uk



**SALES**

**LETTINGS**

**FINANCE**

**LAW**

**WE COVER THE WHOLE OF THE NORTH EAST**

Whitley Bay  
0191 251 3344

Cramlington  
01670 897 213

Tynemouth  
0191 296 6689

Morpeth  
01670 513 966

Ponteland  
01661 820 082

Wallsend  
0191 432 4151

Alnwick  
01665 511 800

Heaton  
0191 432 4275

Forest Hall  
0191 266 9966

Other locations  
0191 640 3523

Newcastle  
0191 640 2284

Durham  
0191 303 8252

Gosforth  
0191 640 3523

Sunderland  
0191 543 6390

Whickham  
0191 432 5102

Gateshead  
0191 432 4294

Jesmond  
0191 281 1037

Killingworth  
0191 640 3602

Ryton  
0191 413 9845

Head Office &  
Lettings  
0191 253 4815

\*Highest recommended 5-star reviews than any other Estate Agent based in the North East on allAgents.co.uk - The UK's Largest Customer Review Website for the Property Industry & Awarded Best Estate Agency 2018 & 2019 - North East England by SME News